

- LEGEND**
- LOT BOUNDARIES

STAGE BOUNDARIES

ROAD CENTRELINE

RAINGARDEN AND OUTLET PIPE

NEW STORMWATER PIPE

(17.4m)
@ CH58.92

NEW STORMWATER LOT CONNECTION

NEW STORMWATER
SINGLE CATCHPIT / DOUBLE CATCHPIT

EXISTING STORMWATER PIPE

EXISTING SINGLE / DOUBLE CATCHPIT

ABANDONED STORMWATER PIPE

STORMWATER MANHOLE
EXISTING / NEW / ABANDONED

GRASSED SW TREATMENT SWALE

FUTURE STAGE

- NOTES**
1. ALL WORKS AND MATERIALS COMPLY WITH THE WAIKATO LOCAL AUTHORITY SHARED SERVICES REGIONAL INFRASTRUCTURE TECHNICAL SPECIFICATIONS (RITS) (MAY 2018).

2. MANHOLES ARE TO BE 1050mm Ø CONCRETE MANHOLES UNLESS OTHERWISE NOTED.

3. PIPES ARE CLASS 2 RCRRJ UNLESS OTHERWISE NOTED.

4. ALL SINGLE CATCHPIT LEADS ARE CLASS 4 RCRRJ 225mm Ø AND ALL DOUBLE CATCHPIT LEADS ARE CLASS 4 RCRRJ 300mm Ø UNLESS OTHERWISE NOTED.

5. PIPE CROSSINGS UNDER ROADS AND ACCESSWAYS HAVE BEEN HARDFILL BACKFILLED.

6. ALL BELOW GROUND ALIGNMENT OF LATERAL LOT CONNECTIONS AND POSITION OF SADDLE CONNECTIONS OF CATCHPITS ON THE MAIN LINES WAS COMPLETED BY ROSS REID CONTRACTORS.

7. LEVELS ARE IN TERMS OF THE MOTURIKI DATUM 1953.

8. ALL CO-ORDINATES ARE IN TERMS OF NZTM.

9. ALL LOT CONNECTION PIPES ARE 100mmØ u-PVC SN16.

CERTIFICATION

I CERTIFY THAT THESE ASBUILT PLANS ARE AN ACCURATE RECORD OF THE WORKS UNDERTAKEN AND THAT:

- THE COORDINATES (X,Y) ARE IN TERMS OF NZTM ON NZGD(2000), AND ARE WITHIN ±0.10m.
- THE LEVELS (Z) ARE IN TERMS OF THE MOTURIKI DATUM 1953, AND ARE WITHIN ±0.01m.

SIGNED

LICENSED CADASTRAL SURVEYOR

DATE:

NAME: NATHAN HOGG

ADDRESS: P.O.BOX 28-345, REMUERA, AUCKLAND

CONTACT: (09) 579 5505

EMAIL: Nathan.Hogg@candor3.co.nz

RELEVANT CONSENT NUMBERS:
SUB0340/18.01 & LUC0137/19

ASBUILT

REV DESCRIPTION		BY	APPVD	DATE	PROJECT		CLIENT		PURPOSE		
					LAKESIDE, TE KAUWHATA STORMWATER LAYOUT STAGE 2 1 OF 2		LAKESIDE DEVELOPMENTS 2017 LIMITED		AS-BUILT		
									DESIGN JS	APPROVED BY NH	SCALE 1:2500 @ A3
									DRAWN JS	DATE MAY 2020	
									CHECK RS		
									PROJECT NO.	DRAWING NO.	REV.
									1239	AB-4-100	-



LEGEND

LOT BOUNDARIES

STAGE BOUNDARIES

ROAD CENTRELINE

RAINGARDEN AND OUTLET PIPE

NEW STORMWATER PIPE

NEW STORMWATER LOT CONNECTION

NEW STORMWATER SINGLE CATCHPIT / DOUBLE CATCHPIT

EXISTING STORMWATER PIPE

EXISTING SINGLE / DOUBLE CATCHPIT

ABANDONED STORMWATER PIPE

STORMWATER MANHOLE EXISTING / NEW / ABANDONED

GRASSED SW TREATMENT SWALE

FUTURE STAGE

- NOTES
1.

ALL WORKS AND MATERIALS COMPLY WITH THE WAIKATO LOCAL AUTHORITY SHARED SERVICES REGIONAL INFRASTRUCTURE TECHNICAL SPECIFICATIONS (RITS) (MAY 2018).
2.

MANHOLES ARE TO BE 1050mm Ø CONCRETE MANHOLES UNLESS OTHERWISE NOTED.
3.

PIPES ARE CLASS 2 RCRRJ UNLESS OTHERWISE NOTED.
4.

ALL SINGLE CATCHPIT LEADS ARE CLASS 4 RCRRJ 225mm Ø AND ALL DOUBLE CATCPIT LEADS ARE CLASS 4 RCRRJ 300mm Ø UNLESS OTHERWISE NOTED.
5.

PIPE CROSSINGS UNDER ROADS AND ACCESSWAYS HAVE BEEN HARDFILL BACKFILLED.
6.

ALL BELOW GROUND ALIGNMENT OF LATERAL LOT CONNECTIONS AND POSITION OF SADDLE CONNECTIONS OF CATCHPITS ON THE MAIN LINES WAS COMPLETED BY ROSS REID CONTRACTORS.
7.

LEVELS ARE IN TERMS OF THE MOTURIKI DATUM 1953.
8.

ALL CO-ORDINATES ARE IN TERMS OF NZTM.
9.

ALL LOT CONNECTION PIPES ARE 100mmØ u-PVC SN16.

CERTIFICATION

I CERTIFY THAT THESE ASBUILT PLANS ARE AN ACCURATE RECORD OF THE WORKS UNDERTAKEN AND THAT:

- THE COORDINATES (X,Y) ARE IN TERMS OF NZTM ON NZGD(2000), AND ARE WITHIN ±0.10m.
- THE LEVELS (Z) ARE IN TERMS OF THE MOTURIKI DATUM 1953, AND ARE WITHIN ±0.01m.

SIGNED

LICENSED CADASTRAL SURVEYOR

DATE:

NAME: NATHAN HOGG

ADDRESS: P.O.BOX 28-345, REMUERA, AUCKLAND

CONTACT: (09) 579 5505

EMAIL: Nathan.Hogg@candor3.co.nz

RELEVANT CONSENT NUMBERS:

SUB0340/18.01 & LUC0137/19

ASBUILT

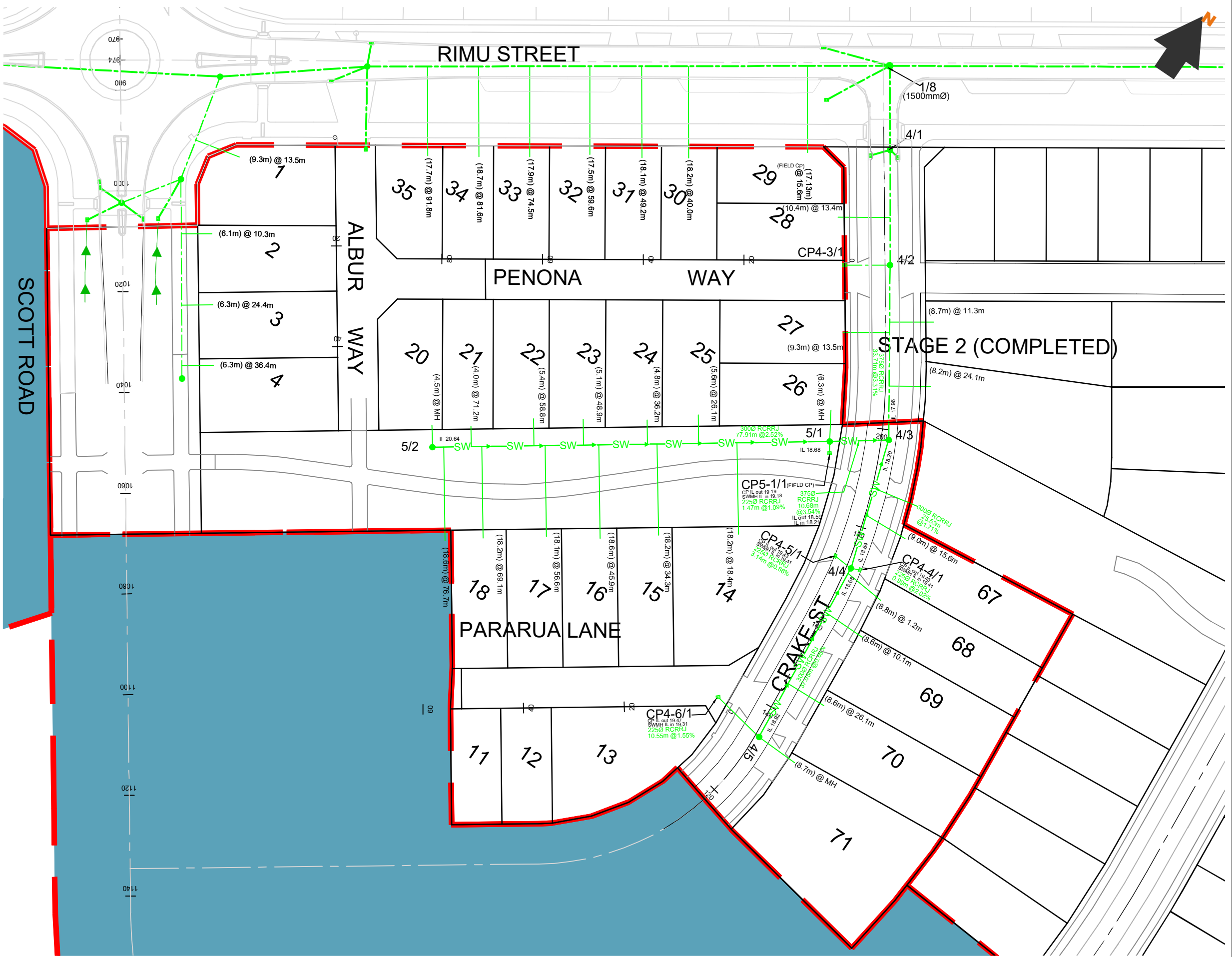

REV	DESCRIPTION	BY	APPVD	DATE	PROJECT	CLIENT	PURPOSE
					LAKESIDE, TE KAUPHATA STORMWATER LAYOUT STAGE 3 2 OF 2	LAKESIDE DEVELOPMENTS 2017 LIMITED	AS-BUILT
							DESIGN JS DRAWN JS CHECK RS
							APPROVED BY NH DATE MAY 2020
							SCALE 1:750 @ A3
							PROJECT NO. 1239
							DRAWING NO. AB-4-101
							REV. -

	PIT ID	NORTHING	EASTING	LID LEVEL	MH Ø(mm)
1	SWMH 4-1	5857088.36	1790232.13	17.65	1050
2	SWMH 4-2	5857069.23	1790244.65	18.50	1050
3	SWMH 4-3	5857040.02	1790263.46	19.80	1050
4	SWMH 4-4	5857014.58	1790271.15	20.56	1050
5	SWMH 4-5	5856976.59	1790274.24	20.65	1050
6	SWMH 5-1	5857033.34	1790253.83	20.21	1050
7	SWMH 5-2	5856989.15	1790188.42	22.27	1050
8	CP 4-3/1	5857064.22	1790237.08	18.56	
9	CP 4-4/1	5857015.31	1790272.81	20.46	
10	CP 4-5/1	5857014.94	1790267.20	20.43	
11	CP 4-6/1	5856978.74	1790263.07	20.69	
12	CP 5-1/1	5857031.39	1790255.03	20.16	

RELEVANT CONSENT NUMBERS:
SUB0340/18.01 & LUC0137/19

ASBUILT

CERTIFICATION

I CERTIFY THAT THESE ASBUILT PLANS ARE AN ACCURATE RECORD OF THE WORKS UNDERTAKEN AND THAT:

- THE COORDINATES (X,Y) ARE IN TERMS OF NZTM ON NZGD(2000), AND ARE WITHIN $\pm 0.10\text{m}$.
- THE LEVELS (Z) ARE IN TERMS OF THE MOTURIKI DATUM 1953, AND ARE WITHIN $\pm 0.1\text{m}$.

SIGNED
LICENSED CADASTRAL SURVEYOR

DATE:
NAME: NATHAN HOGG
ADDRESS: P.O.BOX 28-345, REMUERA, AUCKLAND
CONTACT: (09) 579 5505
EMAIL: Nathan.Hogg@candor3.co.nz

NOTES:

1. SADDLE CONNECTION 'LID LEVEL' SHOWN IN THE COORDINATE TABLE IS THE OBVERT OF THE PIPE AS THERE IS NO LID.
2. COORDINATES PROVIDED IN THE TABLE FOR DOUBLE CATCHPITS IS THE CENTRE POINT OF THE DOUBLE CATCHPIT.
3. THE COORDINATES (X, Y) ARE IN TERMS OF NZTM ON NZGD(2000) AND ARE WITHIN $\pm 0.10\text{m}$.
4. THE LEVELS (Z) ARE IN TERMS OF THE MOTURIKI DATUM 1953, AND ARE WITHIN 0.01m .

REV DESCRIPTION					BY	APPVD	DATE	<div>Candor³</div> <div>ENGINEERING FOR LIFE</div>	PROJECT	LAKESIDE, TE KAUWHATA STORMWATER LAYOUT STAGE 3 STORMWATER COORDINATES	CLIENT	LAKESIDE DEVELOPMENTS 2017 LIMITED	PURPOSE AS-BUILT		
DESIGN					JS	APPROVED			BY NH			SCALE			
DRAWN					JS	DATE			MAY 2020			N/A			
CHECK					RS										
					PROJECT NO.			DRAWING NO.			REV.				
					1239			AB-4-102			-				

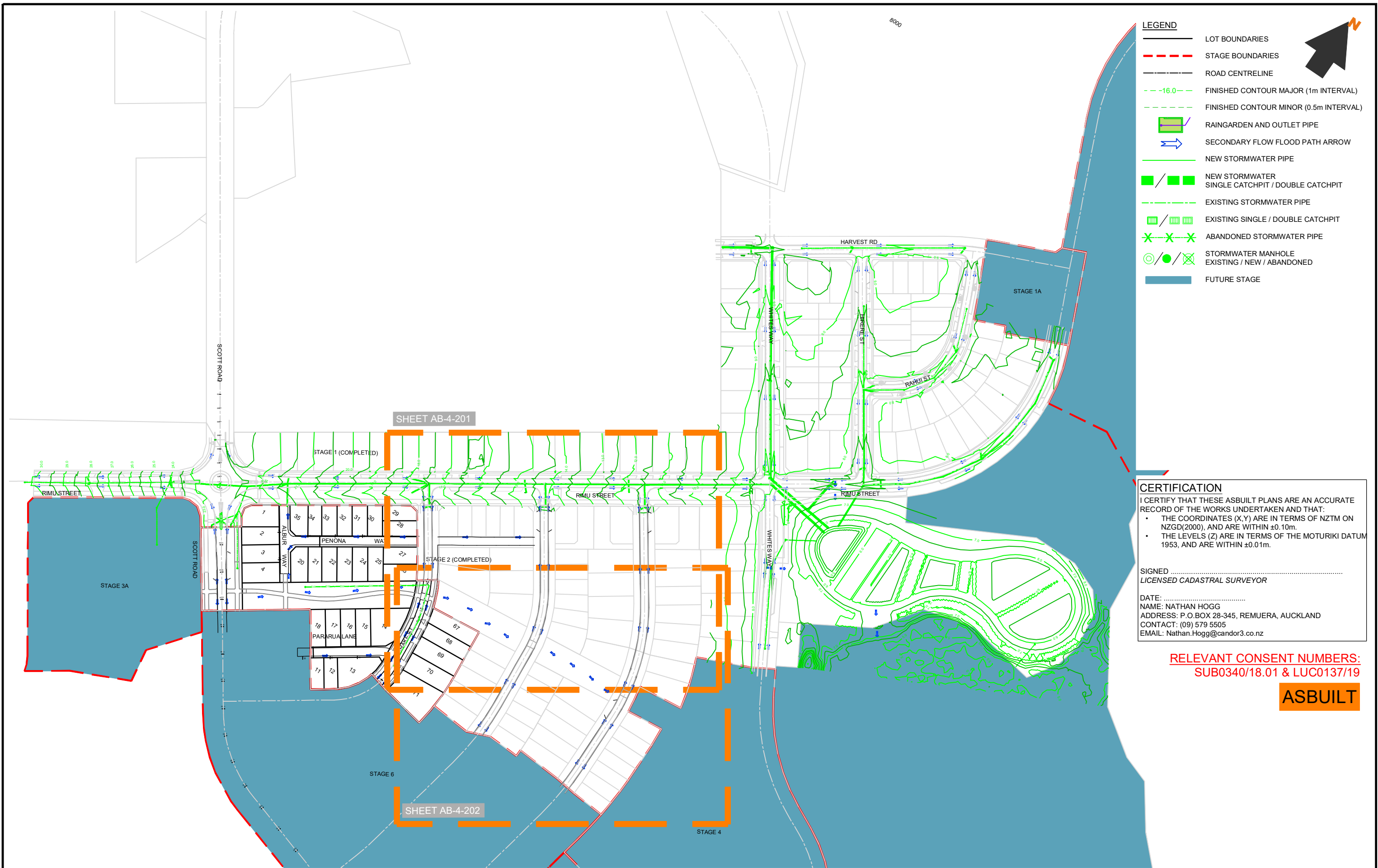

LEGEND

LOT BOUNDARIES

STAGE BOUNDARIES

ROAD CENTRELINE

FINISHED CONTOUR MAJOR (1m INTERVAL)

FINISHED CONTOUR MINOR (0.5m INTERVAL)

RAINGARDEN AND OUTLET PIPE

SECONDARY FLOW FLOOD PATH ARROW

NEW STORMWATER PIPE

NEW STORMWATER
SINGLE CATCHPIT / DOUBLE CATCHPIT

EXISTING STORMWATER PIPE

EXISTING SINGLE / DOUBLE CATCHPIT

ABANDONED STORMWATER PIPE

STORMWATER MANHOLE
EXISTING / NEW / ABANDONED

FUTURE STAGE

CERTIFICATION
I CERTIFY THAT THESE ASBUILT PLANS ARE AN ACCURATE RECORD OF THE WORKS UNDERTAKEN AND THAT:

- THE COORDINATES (X,Y) ARE IN TERMS OF NZTM ON NZGD(2000), AND ARE WITHIN ±0.10m.
- THE LEVELS (Z) ARE IN TERMS OF THE MOTURIKI DATUM 1953, AND ARE WITHIN ±0.01m.

SIGNED
LICENSED CADASTRAL SURVEYOR

DATE:
NAME: NATHAN HOGG
ADDRESS: P.O.BOX 28-345, REMUERA, AUCKLAND
CONTACT: (09) 579 5505
EMAIL: Nathan.Hogg@candor3.co.nz

RELEVANT CONSENT NUMBERS:
SUB0340/18.01 & LUC0137/19

ASBUILT

REV DESCRIPTION		BY	APPVD	DATE	<div>Candor³</div> <div>ENGINEERING FOR LIFE</div>	PROJECT LAKESIDE, TE KAUWHATA STORMWATER OVERLAND FLOW PATH STAGE 3 1 OF 2	CLIENT LAKESIDE DEVELOPMENTS 2017 LIMITED	PURPOSE AS-BUILT		
DESIGN JS								APPROVED BY NH	SCALE 1:2500 @ A3	
DRAWN JS								DATE MAY 2020		
CHECK RS										
PROJECT NO.		DRAWING NO.		REV.						
1239		AB-4-200		-						

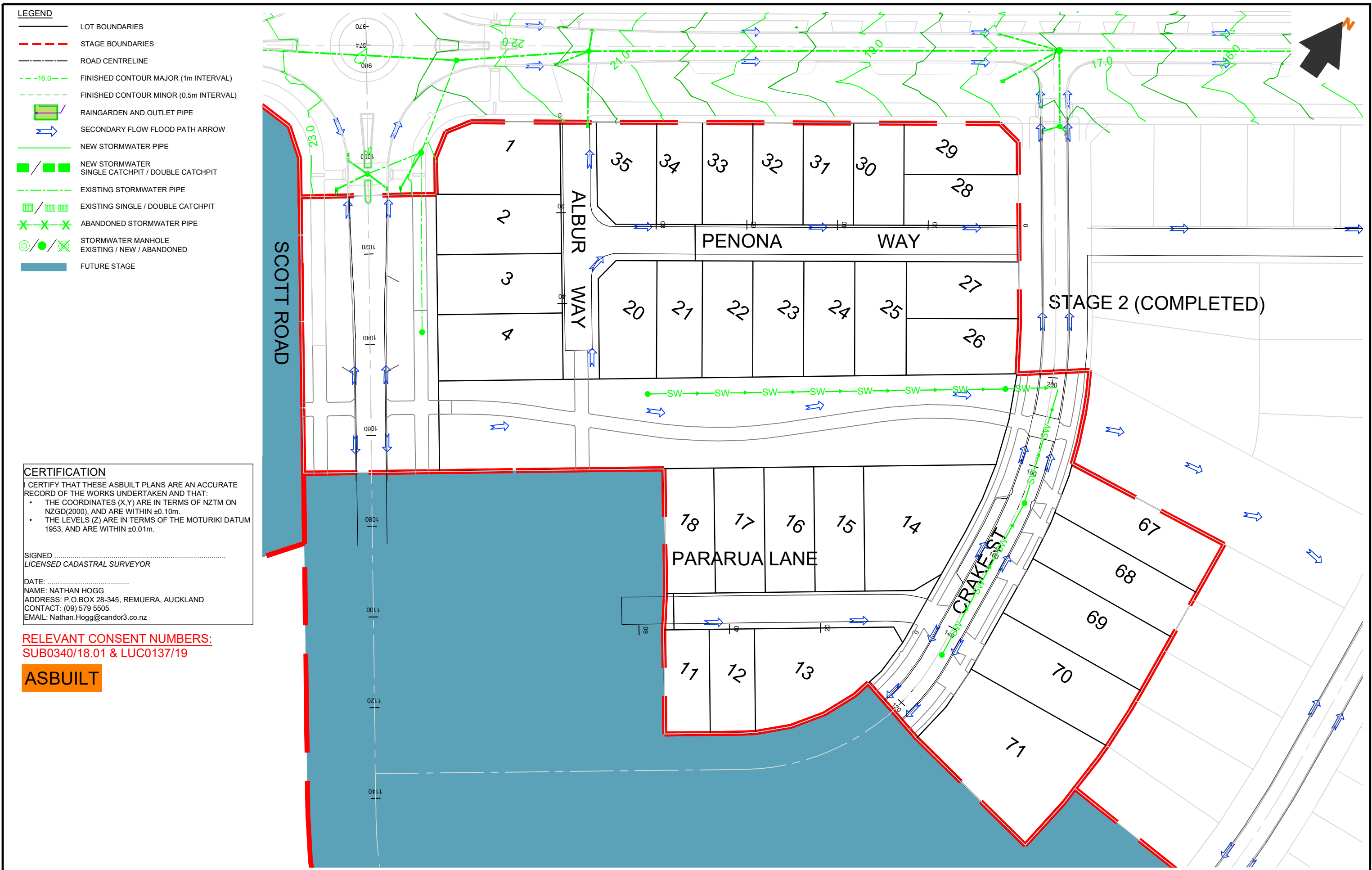

- LEGEND**
- LOT BOUNDARIES
 - STAGE BOUNDARIES
 - ROAD CENTRELINE
 - FINISHED CONTOUR MAJOR (1m INTERVAL)
 - FINISHED CONTOUR MINOR (0.5m INTERVAL)
 - RAINGARDEN AND OUTLET PIPE
 - SECONDARY FLOW FLOOD PATH ARROW
 - NEW STORMWATER PIPE
 - NEW STORMWATER SINGLE CATCHPIT / DOUBLE CATCHPIT
 - EXISTING STORMWATER PIPE
 - EXISTING SINGLE / DOUBLE CATCHPIT
 - ABANDONED STORMWATER PIPE
 - STORMWATER MANHOLE EXISTING / NEW / ABANDONED
 - FUTURE STAGE

CERTIFICATION

I CERTIFY THAT THESE ASBUILT PLANS ARE AN ACCURATE RECORD OF THE WORKS UNDERTAKEN AND THAT:

- THE COORDINATES (X,Y) ARE IN TERMS OF NZTM ON NZGD(2000), AND ARE WITHIN $\pm 0.10\text{m}$.
- THE LEVELS (Z) ARE IN TERMS OF THE MOTURIKI DATUM 1953, AND ARE WITHIN $\pm 0.01\text{m}$.

SIGNED
LICENSED CADASTRAL SURVEYOR

DATE:
NAME: NATHAN HOGG
ADDRESS: P.O. BOX 28-345, REMUERA, AUCKLAND
CONTACT: (09) 579 5505
EMAIL: Nathan.Hogg@candor3.co.nz

RELEVANT CONSENT NUMBERS:
SUB0340/18.01 & LUC0137/19

ASBUILT

REV	DESCRIPTION	BY	APPVD	DATE	PROJECT	CLIENT	PURPOSE
					LAKESIDE, TE KAUWHATA STORMWATER OVERLAND FLOW PATH STAGE 3 2 OF 2	LAKESIDE DEVELOPMENTS 2017 LIMITED	AS-BUILT
							DESIGN JS DRAWN JS CHECK RS
							APPROVED BY NH DATE MAY 2020
							SCALE 1:750 @ A3
							PROJECT NO. 1239
							DRAWING NO. AB-4-201
							REV. -